

**WHIRLPOOL AUSTRALASIA
CONSUMER SERVICES**

SERVICE MANUAL

GAS COOKTOP

**Model AKM157 /WH
Version 8571 157 53010**

**Model AKM157 /IX
Version 8571 157 53000**

This documentation is intended only for qualified technicians who possess the required qualifications and are aware of the regulatory requirements applicable to servicing electrical or gas appliances.

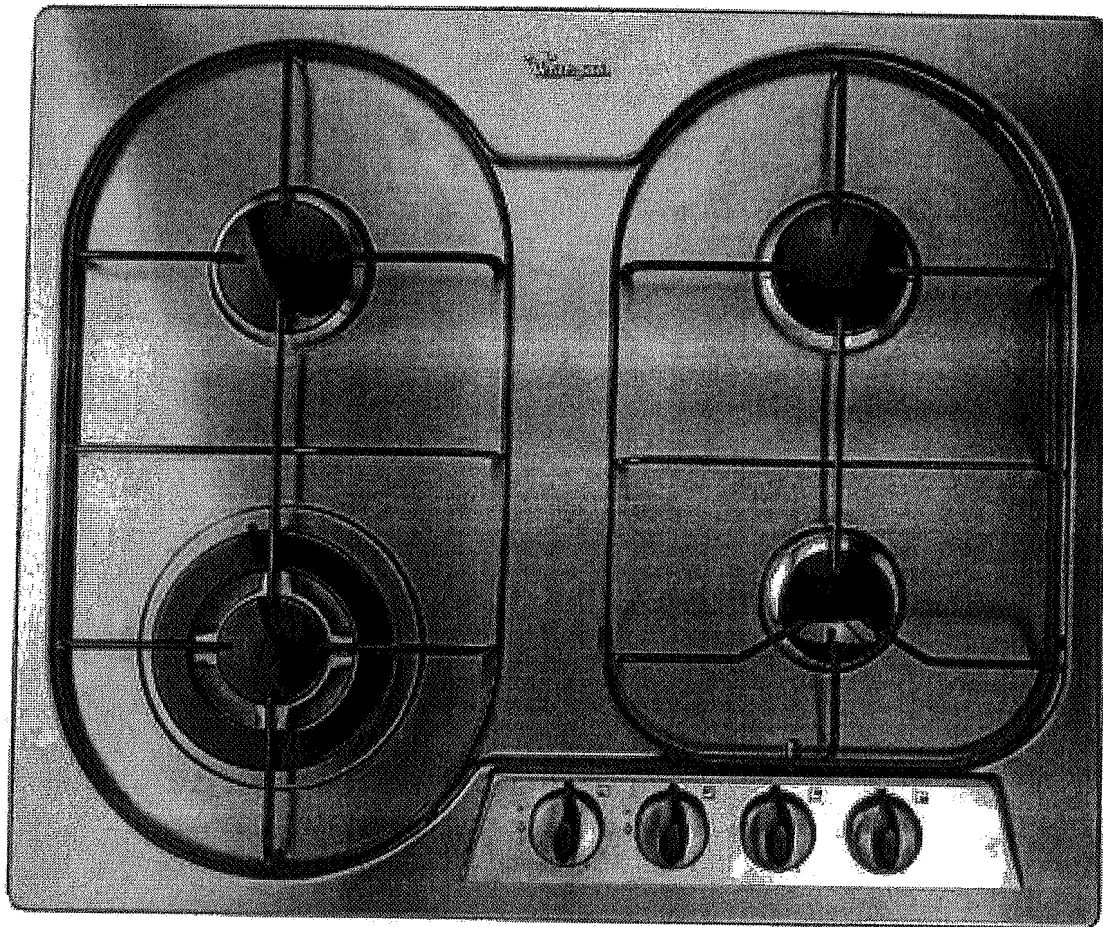

WHIRLPOOL GAS COOKTOP, MODEL AKM157/IX

CONTENTS

	Page
TECHNICAL DATA	4
GAS LEAKS	4
GAS JET REPLACEMENT	4
FLAME ADJUSTMENT	5
MAINTENANCE	
HOB REMOVAL	5
REPLACEMENT OF GAS VALVES	6
GREASING THE GAS VALVES	6
IGNITION COMPONENT REPLACEMENT	7
BURNER BASE REMOVAL	7
CIRCUIT DIAGRAM	7
EXPLODED VIEW - COOKTOP	8
SPARE PARTS LIST	9

TECHNICAL DATA

Burner	Gas Type	Operating Pressure kPa	Rating		Gas Jet (Nozzle)		Output Power	
			g/h	l/h	Diameter 1/100mm	Part No	kW	MJ/h
Small	Propane	2.75	65	-	50	506130	920	3.3
	N.G.	1.00	-	87	86	506126	920	3.3
Medium	Propane	2.75	119	-	68	506131	1670	6.0
	N.G.	1.00	-	159	115	506127	16700	6.0
Wok	Propane	2.75	250	-	102	506151	3500	12.6
	N.G.	1.00	-	334	165	506152	3500	12.6

Note - 0.165 gas jets: 506152 has short castlation and 506128 has longer castlation.

GAS LEAKS

After performing any maintenance or service operation on the cooktop, the cooktop must be checked to ensure that there are no gas leaks.

GAS JET REPLACEMENT

WARNING : Servicing must be carried out only by authorised personnel.

This appliance is approved by the Australian Gas Association for use with either natural gas or propane gas. Ensure that appliance is suitable for the available gas supply.

To replace a gas jet, the following procedure applies:

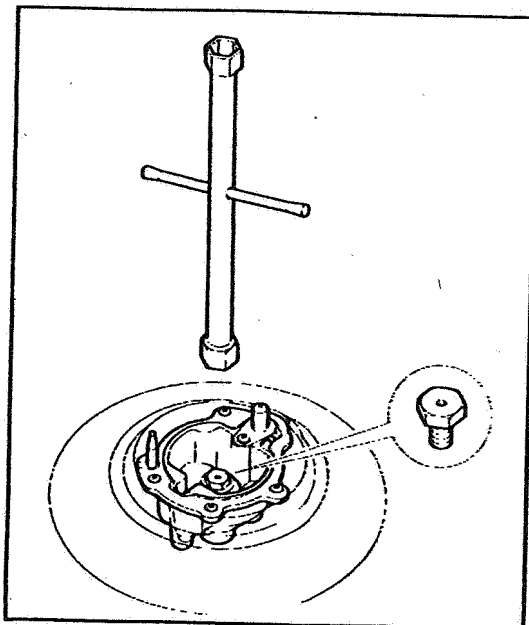

FIGURE 1

1. Turn off the gas cock adjacent to the cooktop.
2. Remove all the burners and unscrew the jets using a 7mm socket. See Figure 1.
3. Reinstall the jet appropriate to the gas supply.
6. Check the cooktop to ensure that there are no gas leaks

FLAME ADJUSTMENT

GAS VALVES

The gas valves fitted to this cooktop are suitable for both propane gas and natural gas.

Adjust the minimum flame for use with natural gas as follows:

1. Operate the burner and set the control knob to minimum flame.
2. Remove the control knob.

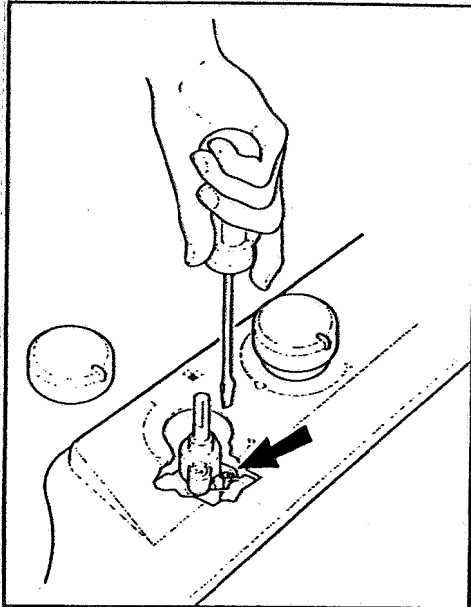

FIGURE 2

3. Using an appropriate sized screwdriver, turn the adjustment screw in the base of the gas valve (See Figure 2). until the flame bead is approximately 4mm long. Check and ensure that the flame does not extinguish when adjusting the control knob quickly from maximum to minimum flame.

Note : For cooktops operating on propane gas, the minimum flame adjustment screw must be fully screwed in (fully clockwise).

4. Check the cooktop to ensure that there are no gas leaks

MAINTENANCE

HOB REMOVAL

To remove the hob from the base, remove all the screws passing through the hob into the top of the burner bases and lift the hob clear of the cooktop base.

To remove the base from the benchtop, isolate and disconnect the gas and electrical supply and release the attachment clamps under the benchtop.

REPLACEMENT OF GAS VALVES

To replace gas valves, remove the hob, remove the two screws securing the manifold to the base and release the compression joints on the output side of the gas valves.

Remove the screws clamping the gas valve to the manifold.

It is recommended that the manifold to gas valve gaskets be replaced whenever the valve is disturbed.

Reverse the procedure for reassembly. Check the cooktop to ensure that there are no gas leaks.

GREASING THE GAS VALVES

If the valves become difficult to operate, they should be greased as follows:

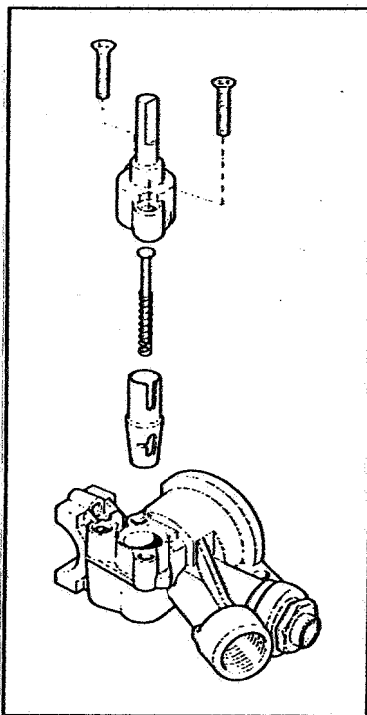

FIGURE 3

1. Dismantle the valve body by removing the two screws located in the body of the valve as shown in Figure 3.
2. Clean the cone and valve body with a solvent soaked cloth. Lightly grease the cone with the appropriate grease
3. Insert the cone and operate the valve several times. Remove the cone again and wipe away any excess grease making certain that all ports are free from obstruction.
4. Reassemble and remount the valve.
6. Check the cooktop to ensure that there are no gas leaks

IGNITION COMPONENT REPLACEMENT

During disassembly, take note of the order of assembly of the components.

1. Remove the hob. (See Figures 1 and 4)
2. The ignition pack can be replaced by freeing the two tabs securing it to the base. All electrical connections are push on.
3. The spark plug for the wok burner is attached to the hob by a circlip in the base of the spark plug. Remove this circlip and withdraw the spark plug and its connecting lead through the top of the burner base.

Replace by reversing this procedure.

4. The spark plugs for the small and medium burners are secured by a single screw in the burner base. Remove this screw and lift the spark plug clear of the burner base.

Replace by reversing this procedure.

5. Reassemble the cooktop ensuring that all wiring is located in its correct position.
6. Test and check all cooktop operations. Check the cooktop to ensure that there are no gas leaks.

BURNER BASE REMOVAL

Isolate the gas and electrical supply and remove the cooktop from the benchtop. Remove the hob, disconnect the compression fittings from the burner base and remove the screw(s) passing through the cooktop base into the bottom of the burner bases.

Reverse this procedure for reinstallation of the burner base.

CIRCUIT DIAGRAM

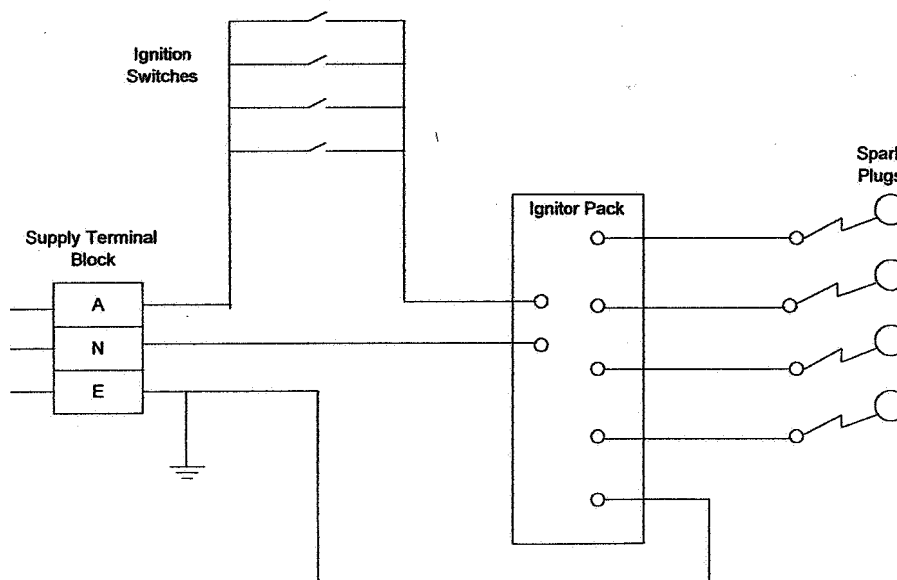

EXPLODED VIEW - COOKTOP

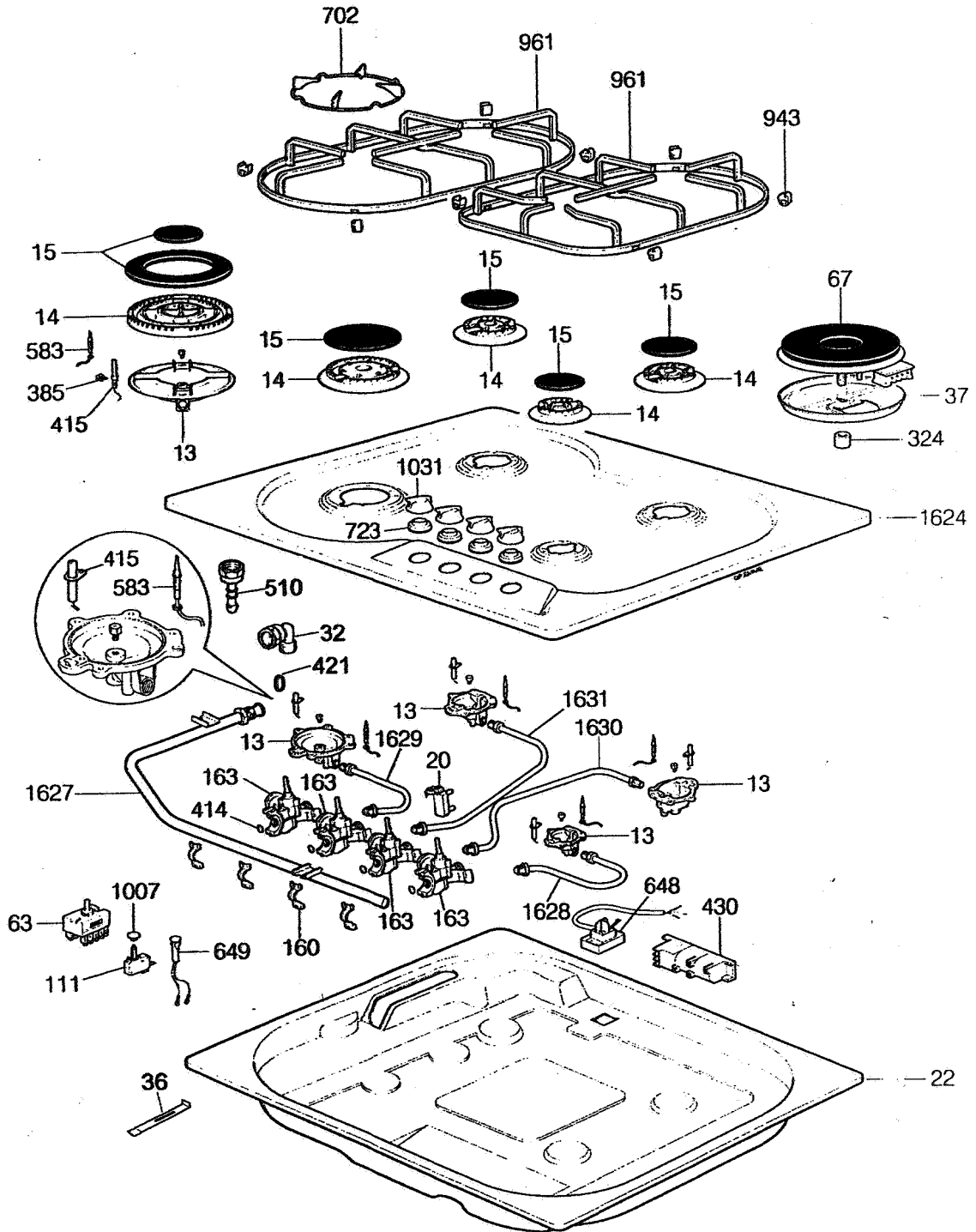

SPARE PARTS LIST

Item	Part No		Description
	AKM157 /WH	AKM157 /IX	
13	510501	510501	Small Burner
13	510502	510502	Medium Burner
13	510506	510506	Ultra Rapid Burner
14	504104	504104	Small Flame Spreader
14	504105	504105	Medium Flame Spreader
14	504108	504108	Ultra Rapid Flame Spreader
15	101208	101208	Cover for Small Flame Spreader
15	101209	101209	Cover for Medium Flame Spreader
15	504117	504117	Cover in for Ultra Rapid Flame Spreader
15	504118	504118	Cover out for Ultra Rapid Flame Spreader
20	604043	604043	Micro for Ignition
22	202283	202283	Load Bearing Bottom
32	505024	505024	Elbow
25	202271	202271	Fixing Hook
160	202287	202287	Bridle for Fixing Gas Valves
163	502113	502113	Gas Valve (Bypass 034)
163	502114	502114	Gas Valve (Bypass 036)
163	502116	502116	Gas Valve (Bypass 070)
319	304001	304001	Benzing 5 Din 6799 for Spark Plugs
385	306024	306024	Stop Spring for Spark Plug
414	411072	411072	Gas Valve Gasket
415	415044	415044	Small/Medium/Rapid/Fish Burner Spark Plug
415	415051	415051	Spark Plug for Ultra Rapid Burner
421	411044	411044	Rubber for Pipe
430	415034	415034	Accumulator
648	601952	601952	Terminal Separator
702	404129	404129	Adaptor for Wok Burner Pan Support
723	411070	411070	Gasket
943	308019	308019	Bumper for Grids
961	404123	404123	Grid for 2 Burners P9 Right Left P6 Left
961	404125	404125	Grid for 2 Burner P6 Right
1031	401533	401532	Knob
1624	102247	210183	Work Table
1627	501396	501396	Gas Collector P640/680
1628	501371	501371	Tube for Auxiliary Burner
1629	501422	501422	Tube for Ultra-Rapid Burner
1630	501369	501369	Tube for Right Back Burner
1631	501367	501367	Tube for Left Back Burner